

DIN 46234 sheet metal terminals 10 - 185 mm<sup>2</sup>

# B10-5R

- dimensions according to DIN 46234
- material: 99.9% Cu, tin plated (Cu/Sn)

Sheet metal terminal for 10 mm<sup>2</sup> copper conductors with an M5 hole in the palm. Used with Elpress certified systems V600, V1300 or V250.

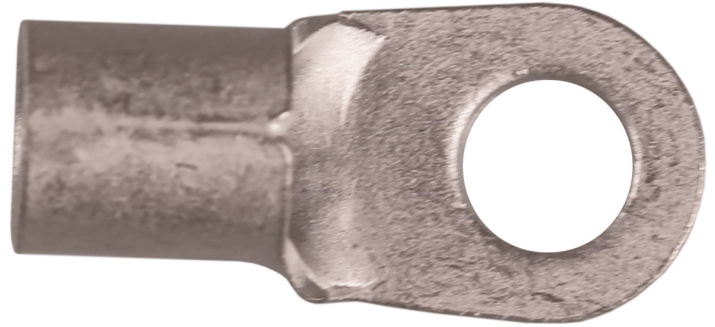

Item number: **7258-265500**

EAN: **7393487018457**

W (mm): **10**

t (mm): **1.1**

d (mm): **4.5**

L1 (mm): **8**

L (mm): **16**

Screw: **M5**

Marking: **10**

AWG/MCM Cu: **8 AWG**

mm<sup>2</sup> Cu: **10**