

Shearbolt terminals 10 - 630 mm<sup>2</sup> (reversible screw)

# SL630R-12X2-40

- shearbolt material: brass for minimum friction
- reversible shear-off shearbolts
- voltage range 1-36 kV
- meets the requirements of IEC standard 61238-1:2003
- the terminals are of the bimetallic type for best functionality

Shearbolt terminal 1-36 kV suitable for both Al and Cu class 1 and class 2 cable, with two M12 hole in the palm. Round cable 500-630 mm<sup>2</sup>.

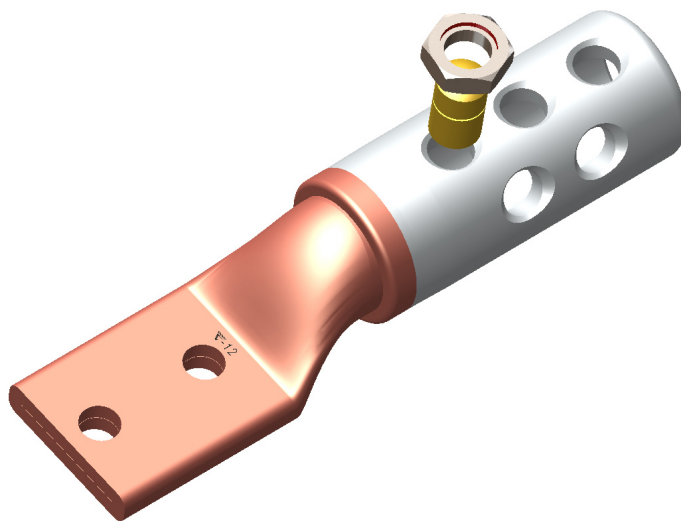

Item number: **7334-011800**

EAN: **7393487040991**

a (mm): **12**

W (mm): **55**

t (mm): **12**

N (mm): **15**

cc (mm): **40**

d (mm): **33**

D (mm): **49**

L1 (mm): **129**

L (mm): **243**

s (mm): **120**

Screw: **M12x2**

Max voltage (kV): **1-36**

Cable type Round (mm<sup>2</sup>): **500-630**