

Aluminium through connectors with partition 16 - 1200 mm<sup>2</sup>

# AS500B

- Used primarily for splicing two Al conductors with the same area.
- Two plus two crimps are needed.
- With partition.

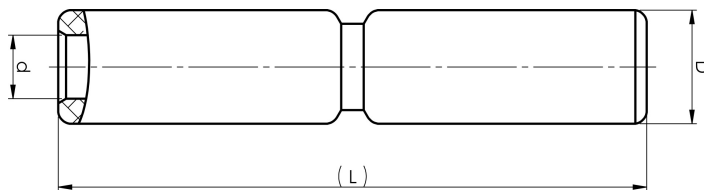

Al through connector with partition for stranded Al cable 500 mm<sup>2</sup>. Used with Elpress certified system V250.



Item number: **7313-022300**

EAN: **7393487022416**

d (mm): **28**

D (mm): **44**

L (mm): **184**

s (mm): **83**

AWG/MCM Stranded Al: **950 MCM**

mm<sup>2</sup> Stranded Al: **500**